

SVTE GLASS-LINED INDUSTRIAL ELECTRIC WATER HEATER

SVTE - 300/400/500/650/800



- Electric water heater for high hot water demand requirements
- Steel tank with glass lining for corrosion protection
- Large sacrificial magnesium anodes for additional corrosion protection
- Maximum working pressure 7 bar
- Manhole 400mm
- RoHS compliant T&P relief valve factory supplied
- Electric element package with incoloy sheathed elements (15 to 60kW)
- Options:
 - Thermometer
 - Factory mounted heating package with control panel including main power disconnect door interlock switch, transformer for 230 Volt control circuit, contactors, step indication lights and override switch, immersion control and hi-limit thermostat.
 - Flexible magnesium anode for installation in confined areas
 - Powered anode for reduced maintenance requirements

SAMPLE SPECIFICATION

The heater(s) shall be State Water Heaters SVTE series electric water heater model number SVTE (300/400/500/650/800) or an approved equal. Heater(s) shall be rated at (15/30/45/60) KW, 400 V, 3 phase, 50/60 cycle AC. The heater shall be for vertical installation. Vessel shall be constructed to European Pressure Directive for 7 bar working pressure. Vessel shall be glass-lined with 3 magnesium anodes for additional corrosion protection. The heater will be insulated with 100 MM insulation with ABS cladding meeting current European standards for energy efficiency. Heater will be supplied with a factory mounted IP55 control cabinet.

Heating elements shall be flange mounted, incoloy 800 sheathed low watt density heating elements. Elements will be switched by magnetic contactors which are operated by a 230V fused control circuit. Control circuit is activated by a master pilot switch. Each element will be switched with an individual thermostat and have an override switch for manual de-activation.

A manual reset high limit will cut-off power to the heating elements if temperature exceeds 95 °C. The entire water heating package shall be prewired to solderless terminal lugs, factory tested, complete with ASME temperature and pressure relief valve. Heater(s) shall have a 3 year tank warranty and 1 year on all electric components as outlined in the written warranty. Fully illustrated instruction manual included.



		STVE 300				STVE 400				STVE 500				STVE 650				STVE 800			
		15	30	45	60	15	30	45	60	15	30	45	60	15	30	45	60	15	30	45	60

General

Input	kW	15	30	45	60	15	30	45	60	15	30	45	60	15	30	45	60	15	30	45	60
Current	A	22	43	65	87	22	43	65	87	22	43	65	87	22	43	65	87	22	43	65	87
Elements	-	1	1	2	2	1	1	2	2	1	1	2	2	1	1	2	2	1	1	2	2
Power supply	VAC/Hz	400 (-15%/+10%) / 50/60 Hz																			
Max. working pressure tank	kPa (bar)	700 (7)																			
Maximum operating temperature tank	°C	95																			
Number of anodes	-	3																			
Max. weight	kg	1267				1897				2254				3003				3361			
Standby loss	kWh/24h	3.5				3.7				4.1				5.6				5.8			

Draw-off capacity Tcold = 15°C/Tset = 60°C

Storage capacity	l	1000				1550				1880				2500				2820			
Max. temperature setting	°C	80																			
30 min. ΔT=45°C	l	944	1,087	1,231	1,374	1,384	1,527	1,671	1,814	1,648	1,791	1,935	2,078	2,144	2,287	2,431	2,574	2,400	2,543	2,687	2,830
60 min. ΔT=45°C	l	1,087	1,374	1,661	1,948	1,527	1,814	2,101	2,388	1,791	2,078	2,365	2,652	2,287	2,574	2,861	3,148	2,543	2,830	3,117	3,404
90 min. ΔT=45°C	l	1,231	1,661	2,092	2,522	1,671	2,101	2,532	2,962	1,935	2,365	2,796	3,226	2,431	2,861	3,292	3,722	2,687	3,117	3,548	3,978
120 min. ΔT=45°C	l	1,374	1,948	2,522	3,096	1,814	2,388	2,962	3,536	2,078	2,652	3,226	3,800	2,574	3,148	3,722	4,296	2,830	3,404	3,978	4,552
Continuous ΔT=45°C	l/h	287	574	861	1,148	287	574	861	1,148	287	574	861	1,148	287	574	861	1,148	287	574	861	1,148
Heating-up time ΔT=45°C	min.	209	104	69	52	324	162	108	81	393	196	131	98	522	261	174	130	589	294	196	147

Shipping data

Weight empty	kg	267				347				374				503				541			
Weight incl. packaging	kg	287				367				394				523				561			
Width packaging	mm	900				1200				1200				1500				1500			
Height packaging	mm	2310				2135				3220				2195				2320			
Depth packaging	mm	1400				1700				1700				1940				1940			

	SVTE 300	SVTE 400	SVTE 500	SVTE 650	SVTE 800
A	2160	1985	2320	2190	2320
D	790	1100	1100	1400	1400
	990	1300	1300	1600	1600
M	170	220	220	220	220
N	2310	2185	2370	2245	2370
R	350	400	400	480	480
S	1075	950	1045	880	1045
T	1805	1500	1690	1380	1610
Z	150	200	200	200	200

1	Cold water inlet	Rp 2
2	Hot water outlet	Rp 2
8	Connection anode	Rp ¾
11	Connection	Rp 2
12	Connection	Rp 2
14	Connection	Rp 2

All dimensions are in mm

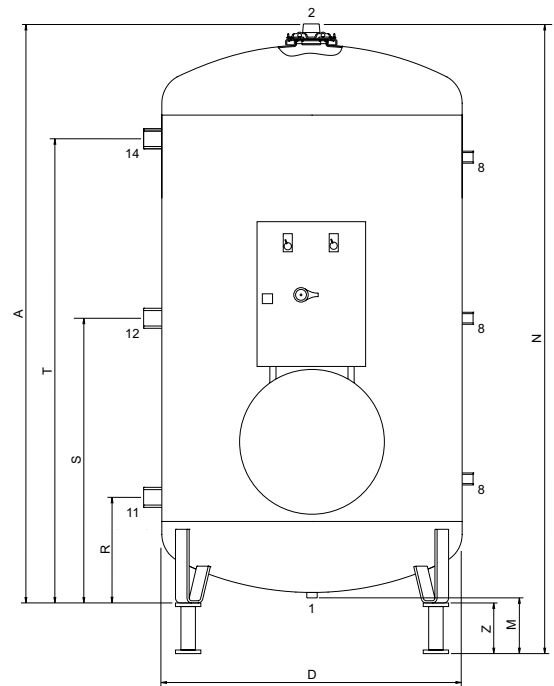

- 1 Pressure reducing valve (mandatory if the mains water pressure is too high)
- 2 Inlet security group combining 8 bar pressure relief valve (mandatory) (15) and check valve (5)
- 3 T&P valve (mandatory - factory delivered)
- 4 Stop valve (recommended)
- 5 Non-return valve
- 6 Circulation pump (optional)
- 9 Drain valve
- 11 Stop valve (recommended)
- 12 Temperature gauge (recommended)
- 15 Pressure relief valve (mandatory)
- 16 Expansion vessel (recommended)

- A Cold water supply
 B Hot water outlet
 C Circulation pipe

In the instruction manual you will find all the necessary information regarding connection, installation and maintenance of the product; including information on the electrical connections.

Information regarding the recycling or disposal of the product can also be found in the manual. This manual is delivered with the appliance and can also be found on our website; www.statewaterheatersme.com

