

# SVT COMMERCIAL STORAGE TANKS

SVT - 80/110/130/180/200/280/400/490/650/735



SVT storage tanks are ideal for use with direct-fired water heaters when extra storage is required to meet high peak demands. The units are manufactured with heavy gauge steel and coated with an exclusive corrosion resistant glass lining, which is fused to the steel by firing at a temperature of 860°C. The range includes 10 different models with storage capacities up to 2820 litres.

- Glass lined steel tank
- Electrolytic protection - magnesium anode
- Removable polyurethane soft foam insulation jacket
- Clean out inspection port
- Maximum working pressure 10 Bar
- Operation temperatures up to 95°C
- Suitable for vented (open) or unvented (sealed) systems
- Optional accessories:
  - Temperature meter
  - Temperature & pressure relief valve
  - Inlet security valve
  - Electric back up with one or two screw in immersion heaters



#### SAMPLE SPECIFICATION

*The tanks shall be State Water Heaters SVT series Commercial hot water storage tank, model number \_SVT\_xxxx (300-3000L) or an approved equal. The tank shall be for vertical installation. Vessel shall be constructed to European Pressure Directive for minimum 7 bar working pressure. Vessel shall be glass-lined, have 1 up to 3 sacrificial magnesium anodes for additional corrosion protection. Entire vessel shall be insulated with 100 MM insulation with ABS cladding. Heat loss will meet ErP standards. The tank will have the option to install a back-up electric element. A combined temperature and pressure relieve valve will be factory supplied.*

		SVT 80	SVT 110	SVT 130	SVT 180	SVT 200	SVT 280	SVT 400	SVT 490	SVT 650	SVT 735	
<b>General</b>												
Storage capacity	l	308	405	499	678	763	1055	1550	1880	2500	2820	
Maximum working pressure tank	kPa (bar)	1000 (10)						700 (7)				
Maximum operating temperature tank	°C	95										
<b>Shipping data</b>												
Weight empty	kg	93	99	131	179	201	262	325	350	485	520	
Maximum weight	kg	401	504	630	857	964	1317	1875	2230	2985	3340	
Weight incl. packaging	kg	104	110	142	190	212	274	415	440	575	610	
Width packaging	mm	780	780	780	870	870	1010	1170	1170	1498	1498	
Height packaging	mm	1510	1850	2150	1930	2150	2100	2060	2248	2120	2195	
Depth packaging	mm	780	780	780	870	870	1010	1426	1426	1680	1680	

	SVT 80	SVT 110	SVT 130	SVT 180	SVT 200	SVT 280	SVT 400	SVT 490	SVT 650	SVT 735
A	1650	1710	2045	840	2035	2005	1985	2175	2045	2070
D	-	600	600	750	750	910	1100	1100	1400	1400
	750	740	760	910	930	1100	1300	1300	1600	1600
F	-	-	-	-	-	-	1190	1341	1220	1270
M	110	70	70	85	85	95	135	135	185	185
N	1460	1655	1995	1805	2000	1965	1985	2175	2045	2170
P	280	410	410	500	500	535	450	450	530	530
R	1050	825	995	1045	1085	1105	710	745	790	790
S	495	510	510	655	655	705	950	1045	980	1045
T	1545	1360	1700	1470	1665	1595	1515	1705	1495	1625
V	-	1095	1350	1260	1380	1355	-	-	-	-
W	-	270	270	315	315	360	385	385	465	465
X	-	355	355	405	405	450	485	485	565	565
Y	-	425	425	485	485	530	585	585	665	665
Z	850	-	-	-	-	-	-	-	-	-

1	Cold water inlet	G 1"	R 2"	R 2"	R 2½"	R 2½"	R 2½"	R 2"	R 2"	R 2"	R 2"
2	Hot water outlet	G 1"	R 2"	R 2"	R 2½"	R 2½"	R 2½"	R 2"	R 2"	R 2"	R 2"
5	Connection circulation	Rp ¾"	Rp ¾"	Rp ¾"	Rp ¾"	Rp ¾"	Rp ¾"	Rp 1¼"	Rp 1¼"	Rp 1¼"	Rp 1¼"
6	Diameter inspection opening	110	115	115	180	180	180	110	110	110	110
7	T&P connection	Rp 1½"	Rp 1½"	Rp 1½"	Rp 1½"	Rp 1½"	Rp 1½"	Rp 1"	Rp 1"	Rp 1"	Rp 1"
8	Immersion well	Rp ¾"	Rp ¾"	Rp ¾"	Rp ¾"	Rp ¾"	Rp ¾"	Rp ¾"	Rp ¾"	Rp ¾"	Rp ¾"
10	Anode connection	Rp 1¼"	Rp 1¼"	Rp 1¼"	Rp 1¼"	Rp 1¼"	Rp 1¼"	Rp ¾"	Rp ¾"	Rp ¾"	Rp ¾"
11	Electrical element conn.	G 1½"	-	-	-	-	-	-	-	-	-
12	Connection	-	Rp 1½"	Rp 1½"	Rp 1½"	Rp 1½"	Rp 1½"	Rp 2"	Rp 2"	Rp 2"	Rp 2"
13	Connection	-	Rp ¼"	Rp ¼"	Rp ¼"	Rp ¼"	Rp ¼"	Rp ¼"	Rp ¼"	Rp ¼"	Rp ¼"
14	Connection	-	Rp 1½"	Rp 1½"	Rp 1½"	Rp 1½"	Rp 1½"	Rp 2"	Rp 2"	Rp 2"	Rp 2"
15	Connection	-	-	-	-	-	-	Rp ¾"	Rp ¾"	Rp ¾"	Rp ¾"

All dimensions are in mm

SVT 80

SVT 110 - 280

SVT 400 - 735

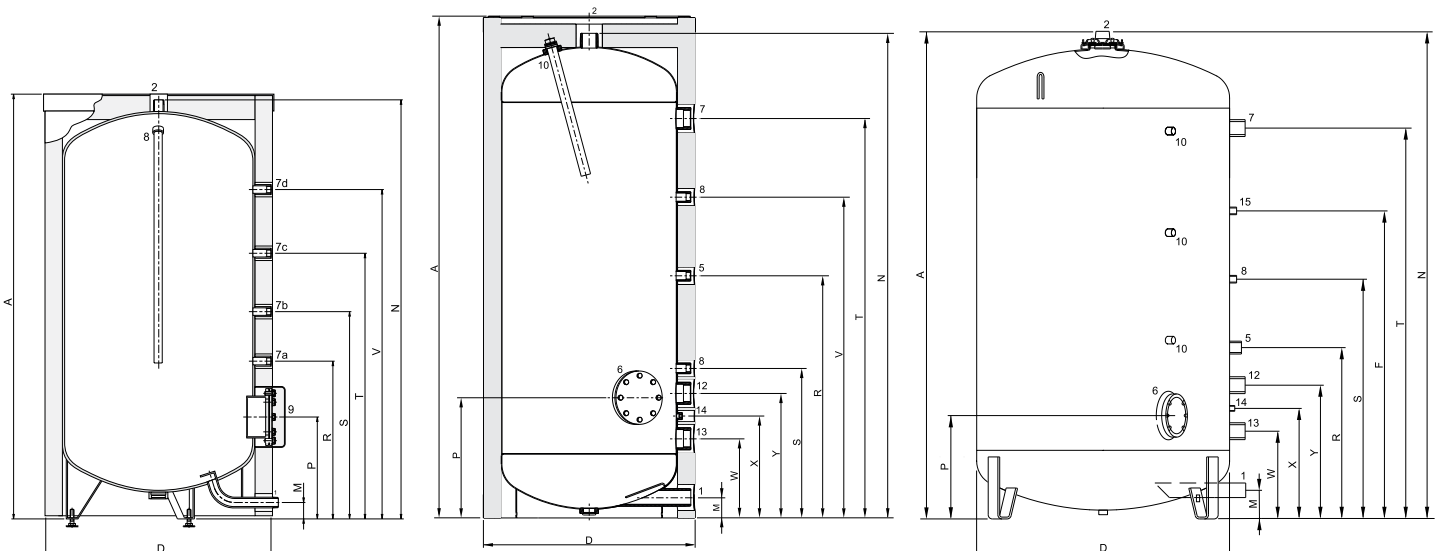

- 1 Pressure reducing valve
- 2 Inlet security group
- 3 T&P valve
- 4 Stop valve
- 5 Non-return valve
- 6 Circulation pump
- 9 Drain valve
- 11 Service valve
- 12 Temperature meter
- 14 Hot water tap

- A Cold water supply
- B Hot water outlet
- C Circulation pipe

In the instruction manual you will find all the necessary information regarding connection, installation and maintenance of the product; including information on the electrical connections.

Information regarding the recycling or disposal of the product can also be found in the manual. This manual is delivered with the appliance and can also be found on our website; [www.statewaterheatersme.com](http://www.statewaterheatersme.com)

SVT 80

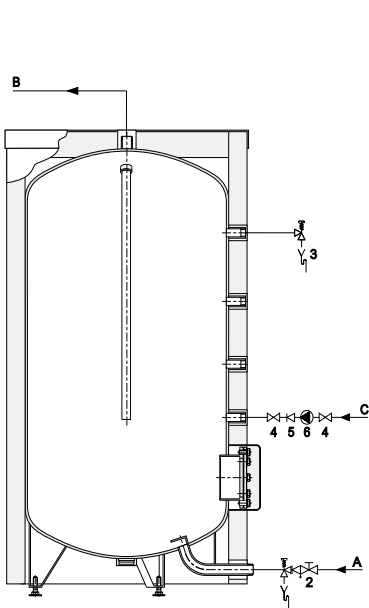

SVT 110 - 280

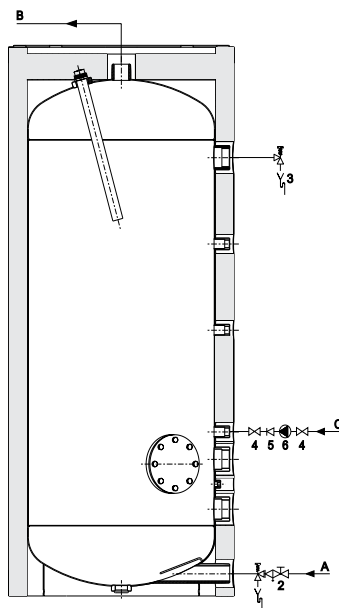

SVT 400 - 735

